

SIDE-L

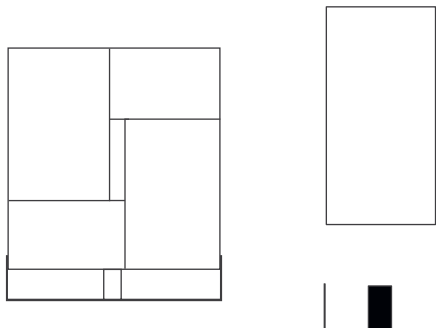

Carcase in 36mm thick plywood. External and internal finish in heat treated Eucalyptus, heat treated Acacia, heat treated Chestnut, heat treated Oak, with hand applied vegetal oil finish based on natural wax and water. Door in 36mm thick plywood, flush with doors, external finish in heat treated Eucalyptus, heat treated Acacia, heat treated Chestnut, heat treated Oak, with hand applied vegetal oil finish based on natural wax and water; internal finish in leather with finishes as per samples. Burnished brass flat hinges for flush doors, base in burnished brass, cover for central partition in burnished brass, internal cross section in burnished brass. All brass burnishing carried out by hand with traditional methods. Internal illumination with cold or warm light energy saving LEDs with automatic ignition by a proximity sensor when the door is opened.

DIMENSIONS

115 cm x 49 cm x 150 cm

Scocca in legno multistrato spessore 36 mm. Con finitura esterna ed interna in Eucalipto termo trattato, Acacia termo trattato, Castagno termo trattato, Rovere termo trattato, finiti ad olio vegetale a base di cere naturali e acqua. Ante in legno multistrato spessore 36 mm, filo cassa, finitura esterna in Eucalipto termo trattato, Acacia termo trattato, Castagno termo trattato, Rovere termo trattato finiti a olio vegetale a base di cere naturali e acqua; interno in pelle nelle finiture a campionario. Cerniere piane per ante a filo in ottone brunito, basamento in ottone brunito, carter del divisorio centrale in ottone brunito, crociera interna in ottone brunito. Tutte le bruniture dell'ottone sono realizzate a mano secondo le tecniche tradizionali. Illuminazione interna con led luce fredda o calda, basso consumo con accensione automatica ad apertura anta mediante sensore di presenza.

DIMENSIONI

115 cm x 49 cm x 150 cm

